

TURNSTILE RANGE

4000 Turnstile



Single | Double | Stainless | Bespoke



Features

- 100% duty cycle heavy industrial usage
- Force tested to 1200Newtons
- Single Phase Supply
- Plug & Play installation
- Programmable control panel c/w fault diagnostic on screen display
- Fire alarm input built in as standard (engages free rotation)
- High specification turnstile to control schools/arenas and un-authorised access to secure areas
- Seamlessly forms part of the existing fence lines perimeter security
- Mild or stainless steel for long lasting and maintenance free performance
- 90° or 120° rotor assemblies available
- Bi-directional or single direction only
- Fail Safe or Fail Secure modes in the event of power failure

4000 Added Benefits

- Ease of installation
- Low maintenance
- 99.9% Access Control Compat
- Reader Plates Fitted as STD
- Fire Alarm Input pre-configured
- Paxton/Nortech/Ievo Compat
- Easy to use for end users

Optional Extras

- Pedestrian Rain Canopies
- LED Passage Indicators
- Stainless Steel Rotors/Frames
- Different Heights Available
- Bespoke Size Reader Plates
- LED Courtesy Down light
- Heel Guards
- Pedestrian Gate Combination

The 4000 Full Height Turnstile range is a high specification turnstile, suitable for controlling access in environments such as reception areas, schools, public building and military bases.

Our Turnstiles seamlessly form part of high level perimeter security, requiring low usage knowledge.

Constructed from Mild or Stainless Steel for long lasting and maintenance free performance, the 4000 offers a comprehensive range of features to suit individual client requirements, including 90° or 120°

rotor assemblies, canopies, down lights and fire alarm activation (to engage free rotation).

Turnstiles can be configured as bi-directional or single direction only.

The 4000 turnstile range is available in single or double according to your requirements. The units are ready to bolt down and

commission continuing our "Plug & Play" ethos.

Due to our superior intelligent yet simple, PLC controller. The turnstile can be configured for "Fail Safe" or "Fail Secure" modes on the event of power failure. Options also extend to varying height configuration, again tailored to suit your needs.

4000 Turnstile

01977 701566

info@gmcfabservices.co.uk



www.gmcfabservices.co.uk

TURNSTILE RANGE

4000 Turnstile



Single | Double | Stainless | Bespoke

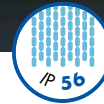

Product Specifications

Flow Rate	15 to 22 Person Per Minute in Single Direction Fail Safe or Fail Secure Modes Available
Duty Cycle	100% Heavy Industrial Usage Suitable for Indoor & Outdoor Usage
Specification	CE Approved, TUV Approved
Power Requirements	Single Phase 240v 50Hz 5 Amps
Colours	All RAL Colours Available (Galvanised Optional Cost)
Dimensions	Single: 1280mm x 1400mm x 1790mm Double: 2450mm x 1400mm x 1790mm
Sizes	Rotor: 76mm Tube with Bottom Supported Bearing Arms: 42mm Tube with Capped Ends Side Frames: 33mm Tube Welded to Curve Base Plate
Material Construction	Mild Steel Primed & Powder coated as standard Galv Optional
Unit Weight	230Kg Approx

Safety System

Built in as standard is an antitrap safety system to stop the possibility of users getting trapped in the turnstile



Superior Mechanism

The 4000 turnstiles features an ultra smooth and reliable Locinox Head Mech unit

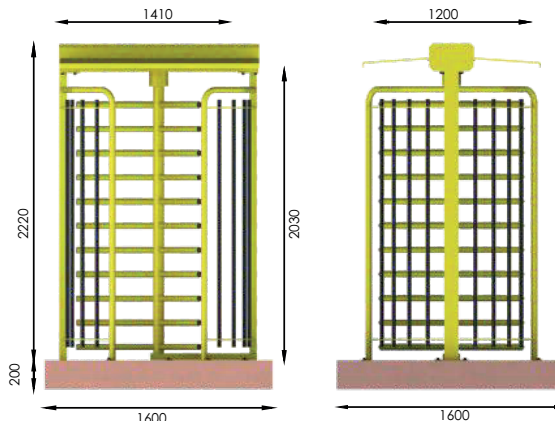
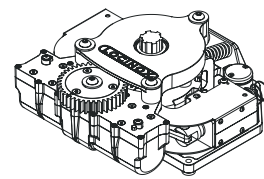

Delivered on our Fleet of Hi-Ab Vehicles, ready to bolt down/ connect power and commission.



4000 Turnstile